



FR 1200

Outdoor Slave Fingerprint Reader

IP 65 rated Fingerprint Slave Reader for ZK inBio panels and standalone reader controllers



Small Form Factor:

Sealed Enclosure with slim and attractive design are ideal for indoor and outdoor mounting.



Communication:

FR1200 can be connected to RS485 port of any ZK's inBio Panel or Standalone reader controllers.



Easy Operation:

Once user places their finger on FR1200 its fingerprint is matched by either ZK's standalone reader controller (master reader) or ZK's inBio Panel. It also provides Visual indication for acceptance/rejection of the fingerprint of the users.



Waterproof enclosure:

FR1200 is an IP65 rated waterproof reader that can be used for many outdoor applications. The cables and connectors are epoxy sealed at the back of the reader.



Options:

FR1200 is an IP65 rated waterproof reader that can be used for many outdoor applications.

Installation with inBio

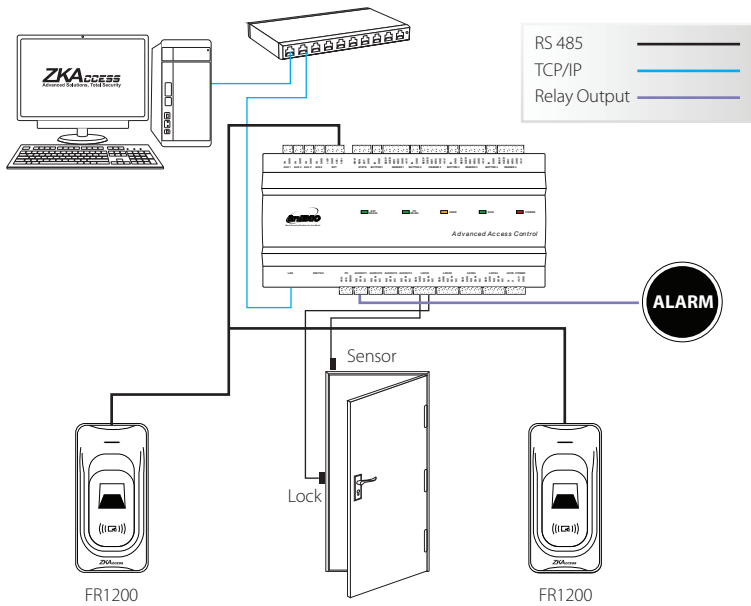

Master/Slave Standalone Installation

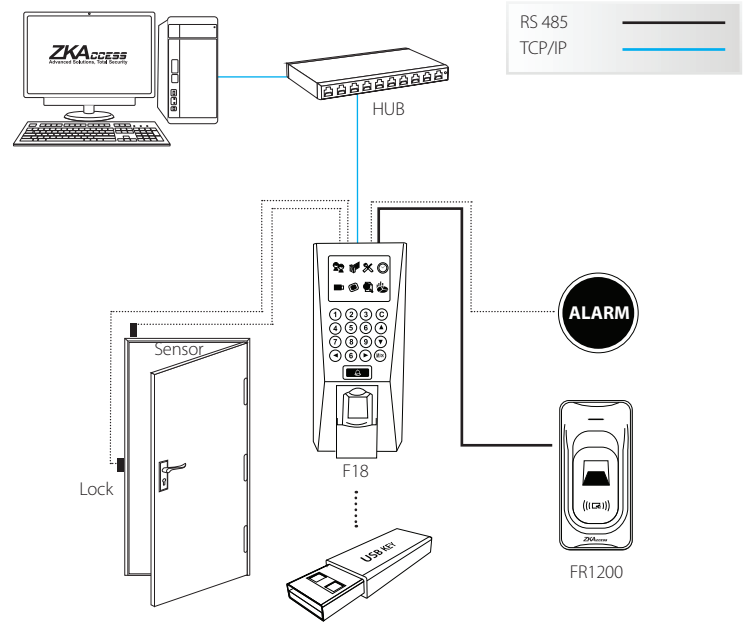

Specifications

Communication

RS485

Power

12V DC, 1A

Environment

Operating Temperature: 32° to 113° F (0° to 45° C)

Operating Humidity: 20% to 80%

Optional Function

Mifare Card

Dimensions

Length: 3in (7.62cm)

Width: 1.6in (4cm)

Depth: 1.1in (2.8cm)

Weight: 0.27lbs (0.12kg)

Waterproof Enclosure

IP65 Rated

Part Numbers

FR1200

FR1200-ID with ID card reader

FR1200-M with Mifare card reader

What's in the Box

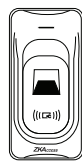

FR1200

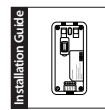

Installation Guide

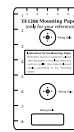

Installation Template

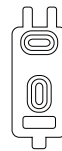

Back Plate

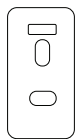

Rubber Gasket



ID Card



Screws

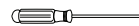

Screwdriver



Design and Specifications subject to change without notice

6 Kingsbridge Road, Suite 8

Fairfield, NJ 07004

+1 862 505 2101

sales@zkaccess.com

zkaccess.com